

CRYSTAL CITY INSIDER

The monthly newsletter of the Crystal City Civic Association



April 2021

A MESSAGE FROM THE PRESIDENT

We are gradually modernizing our CCCA procedures and media. We will be issuing more frequent emails to keep you up to date on meetings and issues in coming weeks. In this issue, we are including a survey to ask members what you like, dislike, or would like to see in the Newsletter in the future. Please help by responding.

- Carol Fuller, CCCA President

COVID NEWS

Arlington Partners with Amazon to Open New Vaccination Clinic

Arlington County is partnering with Amazon and JBG Smith to open a new vaccination clinic by the company's HQ2 offices in Crystal City. The clinic at 2100 Crystal Drive (the former Tech Shop) opened Monday, March 29, for preregistered eligible priority groups. As with all existing Arlington County vaccination clinics, all vaccinations are by appointment only. There are no walk-up vaccinations available.

Vaccine Distribution Update

As of March 27, the Arlington County Public Health Division (ACPHD) has used 98% of first doses received. To date in Arlington County, according to VDH's Vaccine Summary Dashboard, a total of 78,622 doses have been administered, and over 26,000 people are fully vaccinated.

CIVIC ASSOCIATION AND LIVABILITY 22202 ISSUES

Help Improve the CCCA Newsletter

We would like to modernize and improve this Newsletter for our CCCA members. Please help us do so by filling out the attached [survey](#).

March 17 CCCA Meeting

Excellent Meeting—Very informative. You can see the exciting presentation on Project Journey at National Airport by the Metropolitan Washington Airport Authority (MWAA) [here](#). The new terminal will open by summer. The work on the security checkpoints is ongoing. You can see the presentation by the Arlington County Police Department about Outreach and prevention in 22202 [here](#), crime statistics compared for the first 3 months of 2019-2021 [here](#), and crime statistics for the entire years of 2018-2020 [here](#). The lists are broken down by civic association in 22202 and by the crime established by Virginia statutes. You can also see the timeline updates for Upcoming Meetings [here](#) and for Development and Other issues [here](#).

The meeting was recorded on the CCCA Facebook/Live streaming page and can be seen here: <https://www.facebook.com/crystalcitycivic/live>.

CRYSTAL CITY (AND NEARBY)

Development/Construction Timelines (TBD)

The following timelines are very tentative but will give residents an idea of what to expect and when from a variety of projects. We will go over these timelines at our CCCA meetings as well.

Upcoming Meetings:

- April 5, 7-9 pm, Bicycle Advisory Commission, [Crystal City Bike Plan](#)
- April 5, 7-8:30 pm, [Airport noise study workshop #2](#), meeting information and detailed agenda to follow
- April 12, 7-9 pm, [2000 S Bell/2001 S Clark Streets](#): Joint LRPC/Final SPRC; Planning/Transportation Commissions and County Board in April; County Board in May; details and login to come
- April 17, 9-11, [Earth Day Cleanup](#)
- April 19, 7-9 pm, LRPC #1, [PenPlace](#) (Amazon HQ2)
- April 21, 6:30-8:30 pm, [Retail Community Forum](#); JBG Smith will share the latest on evolving retail trends (primarily street level) and how they inform their planning and overall retail strategy for Crystal Drive, Crystal City and the National Landing area. A second meeting on the Underground is planned for later.
- April 22, 7-9 pm, [Eads St/Army Navy Drive Teardrop park](#), Forestry and Natural Resources Commission
- April 26, 6:30-8:30, [Pentagon City PDSP](#); details and login to come
- April 27, 7-8 pm, [Crystal City Building Height Study](#); details and login to come
- April 27, 7-9 pm, [Eads St/Army Navy Drive Teardrop park](#), Parks & Recreation Commission
- April 28, 7-9 pm, [Crystal City Bicycle Network](#), Community Meeting #2

Other Issues:

- [Crystal Square Central District Construction/Opening](#): Staged openings in 2021; CVS now open; *Mah Ze Dahr Bakery* may open in April; *Tacombi* and coming later in the year; *grocery* still not announced and internal build out not started; *Alamo Draft House* last to open due to COVID but build out could take a year
- [1900 Crystal Drive construction](#): 3 years construction, started end March
- [2000/2001 S Bell](#): preparation work for demolition of 2001 Richmond Hwy starts April 12 with the Underground from 20th to Crystal City Shops closed; when demolition of the tower starts end May, Underground passage will close for about 3 ½ years
- [Water Park redesign](#): approved by County Board March 20; construction to start in Fall with target completion spring 2023
- [2121 Crystal Drive \(Dining in the Park\)](#) site plan amendment (approved at December County Board); no construction earlier than end 2021 with summer 2022 opening if a restaurant tenant lease is signed in 2021
- [Marriott Residence Inn, Army Navy Drive](#): building demolition to be completed by June 2021
- [VRE Design for New Station](#): final design 2021-2022; award and construction 2022-2024
- [101 S 12th Street](#): approved by County Board December; no construction in 2021 until tenant signed; Gateway Park design when construction finished in 2-3 years
- [Long Bridge Aquatic Center](#): target construction completion/opening summer 2021

- Boundary Channel (VDOT): award contract summer 2021; construction 2022; target construction completion fall 2023
- MetPark Amazon HQ2: Target construction completion mid-2023

[The National Landing BID also has a useful map showing all ongoing and potential projects.](#)

Livability22202 Open Space Working Group Meeting March 2

COVID has shown us how important it is to have parks, trails, and open spaces. Yet 22202 is very lacking in those amenities, except for Virginia Highlands Park and Long Bridge Park. As demonstrated by three recent meetings, we're starting to have an impact. But it's **soooo** important to expand membership of the working group to ensure participation, not only geographically across 22202 but also demographically, with emphasis on renters in high rise multifamily buildings needing access to open space And not just during the COVID pandemic, but year round. An Arlington County Civic Federation White paper shows residents in multifamily units have some of the least access to open space in the County.) Not a surprise to us, is it? We are looking for your ideas and input. You can see the slideshow presentations from the **March 2** meeting [here](#).

Earth Day Clean Up - 17 April 2021 (rain date 24 April)

Join the National Landing BID and Livability 22202 to clean up the wooded area along the GW Parkway south of the Mount Vernon Trailhead at the Crystal City Water Park to the access road on 26th St South. (And get a look at some what may someday become accessible open space for our 22202 community.) Start time: 9-10am (*rolling registration in 15 minute pre-selected intervals; we expect most volunteers to be out no more than 2 hours*). Volunteers will be provided with all the necessary materials (bags, gloves, etc.) courtesy of the Alice Ferguson Foundation. Pre-registration is required as space is limited due to health and safety restrictions related to COVID-19. Masks are required to be worn at all times during the cleanup. After the cleanup, volunteers will exchange their collected trash for swag and a tasty treat! [Sign up now](#) to help keep National Landing green and clean!

Project HUG (Highlands Urban Park)



Our Livability Open Space project with the Friends of Urban Agriculture has entered the next phase of planning for spring planting. On March 21 HUG volunteers built the cinder block stands for the water tanks, turned over the soil in half of the plot (the other half was not turned over as an experiment), and put up the project signs at both ends of the garden. The art work for the water tanks is being done by the National Landing BID and should be ready soon to coincide with the National Cherry Blossom Festival activities planned for Virginia Highlands Park from March 19-April 11. (See the

[Aurora Highlands Civic Association website](#) for details) The smaller signs for the individual plantings will be done later.

Stage 1 (now through April): From the last weekend in March through April we can plant directly in the ground: kale, lettuce, spinach, pole beans. Stage 2 (end of April/early May): 2 types of basil, tomatoes. We would love to have more volunteer gardeners. Fill out the [Volunteer Application Form for FOIA](#) in advance. This is required for FOIA insurance purposes and is not onerous. See the project on the [County website here](#) and on the [FOIA website here](#).

The VDOT Route 1 Multimodal Feasibility Study

According to the [VDOT project website](#), the study on Route 1, from approximately 12th Street to 23rd Street South, will explore an at-grade urban boulevard, but also review and compare potential improvements to the current elevated condition, and the elevated urban boulevard described in the Crystal City Sector Plan. At its **March 3** Public Information Meeting, VDOT presented 3 options for Route 1: no build, the CCSP ideas, and an at-grade construction. Livability provided comments emphasizing that *“From our perspective, there's no apparent full at-grade configuration that will provide both adequate safety for east-west walking and biking and prevent excessive traffic from diverting onto parallel streets. If either build concept is recommended in the end, the community would prefer some or all of the CCSP options. We recognize that the CCSP alternative in this study may not address other concerns about aesthetics and development potential, and we reiterate our hope that a future study formally considers a wider range of alternatives for a longer portion of this corridor, as a more holistic corridor plan may better balance all of the competing needs.”* You can see the full letter with comments on the [Livability Route 1 working group website](#). Livability22202 has also sent [a letter to our Virginia legislators](#) about our concerns.

Amazon HQ2 Kick Off Community Meeting

Arlington County kicked off the review process for PenPlace, the second proposed phase of Amazon's HQ2, on March 25. For PenPlace, located at the intersection of Army Navy Drive and S. Eads Street, Amazon is proposing 3.3 million square feet of solar-powered office space divided among the lush, futuristic building, dubbed “The Helix,” and three, 22-story office buildings with ground-floor retail. The 11-acre site, which could accommodate up to 16,000 employees, will also have 2.5 acres of public open space, three retail pavilions and child care. A network of 2,100 parking spaces and loading areas for trucks will all be underground. County officials say there will be numerous opportunities for virtual public



engagement and are encouraging people to get involved in the process. The next step is a Long Range Planning Committee (LRPC) meeting, tentatively scheduled for **April 19** and then **May 12**. The County Board is anticipated to hold a public hearing on PenPlace by the end of 2021. All four buildings are slated to be fully built by the end of 2025. You can view the [March 25 meeting here](#), as well as the [Staff Presentation](#) and [Applicant Presentation](#).

Construction to Close Lane and Sidewalk at 1900 Crystal Drive

The general contractor will begin the following closures associated with 1900 Crystal Drive construction on March 29th and they will continue progressively over the next two weeks. Please contact the team at 1900CrystalDrive@jbgsmith.com with any questions or concerns.

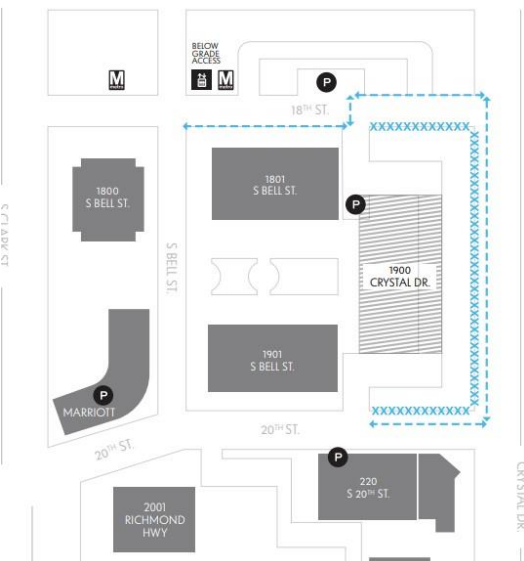

The general contractor will begin the following closures associated with 1900 Crystal Drive construction on March 29th and they will continue progressively over the next two weeks. Please contact the team at 1900CrystalDrive@jbgsmith.com with any questions or concerns.

- Southern 18th Street sidewalk from Crystal Drive to 1801 S. Bell St. will be closed.
- Southern 18th Street parking lane from Crystal Drive to 1801 S. Bell St. will be closed.
- Southbound lane of Crystal Drive from 18th street to 20th street will be shifted east.
- Western parking lane on Crystal Drive from 18th street to 20th street will be closed.
- Western sidewalk on Crystal Drive from 18th Street to 20th street will be shifted east into a jersey barrier protected lane.
- Northern parking lane on 20th Street from Crystal Drive to

1901 S. Bell St. will be closed.

- Northern sidewalk on 20th Street from Crystal Drive to 1901 S. Bell St. will be shifted south into a jersey barrier protected lane.

Preparation Site Work at 2001 Richmond Highway

Starting **April 12**, JBG SMITH will begin preparation site work at 2001 Richmond Highway,

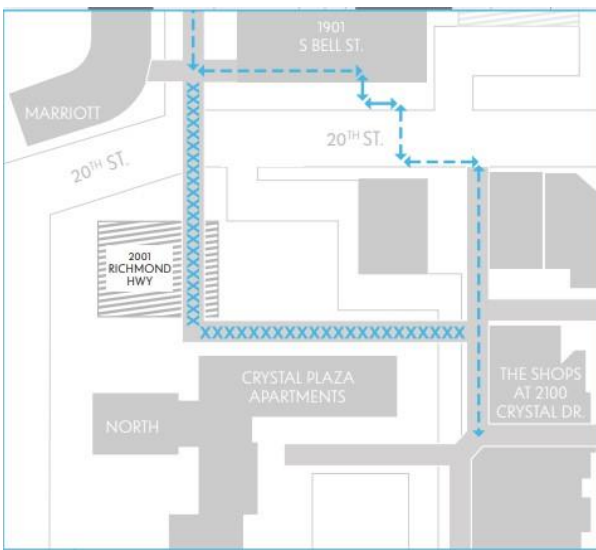

demolishing the building. Demolition of the existing building at 2001 Richmond Highway (corner of 20th Street) is possible without approval of the new site plan. The Underground connection beneath the existing 2001 Richmond Highway building will be closed to complete a month of site enablement activities. Once tower demolition of that building starts, for safety purposes the Underground connection will be closed for the duration of construction on the site. The earliest tower demolition date is late May, but there is no firm date.

You should expect the following changes:

- A portion of the Underground retail/metro corridor between Crystal Drive and 20th Street will be closed for about a month; pedestrians will need to cross 20th Street outside and re-enter the retail/metro corridor at 1901 S. Bell or 220 20th Street.
- All retail shops will remain open and unaffected.

- When tower demolition begins, the Underground passage will close for about 3 ½ years.

[Please reference the maps](#) for more detailed information regarding the retail/metro corridor and sidewalk closures.

Crystal City Water Park renovation

On March 20 the County Board approved JBG Smith's site plan amendment to renovate the Crystal City Water Park at 1601 and 1505 Crystal Drive. The approved plan includes adding retail shops, cafes, and restaurants along the edges of the park, upgrading the existing water wall, and adding a new water feature, adding public art and an outdoor bar, and improving the connections to the planned Virginia Railway Express station and the Mount Vernon trail connector. Accessibility and visibility into the park, particularly the upper terrace area, will be enhanced, a performance space added. Landscaping, seating, and trailhead restroom facilities will also be added. JBG Smith made numerous modifications to its plan in response to community feedback and the final plan is much better as a result. The developer still has 3 hurdles to jump before potential construction in the fall: a civil engineering plan, a final landscaping plan, and permit submissions. Access to the park will then be blocked until spring 2023.

SPRC for 2000/2001 Clark/Bell Site Plan

The **March 18** SPRC focused on project updates, Transportation, and PDSP/Community Benefits. JBG has agreed to enclose the new Underground passageway from 20th Street to the Crystal City Shops with a half glass wall—a major concession. The pedestrian plaza from 20th Street to the Crystal City Shops has also been improved, with more greenery and a swerved ramp to break up some of the linearity. The final joint LRPC/SPRC will be **April 12**. You can learn more about the project by visiting the [project website](#).

Metro Second entrance Q&A March 31

The County held a live Q&A session on **March 31** for the Crystal City Metro Station East Entrance Project. Design work is underway for the project to add an east entrance to the Crystal City Metro station. Staff talked about the design process, environmental review activities and what to expect from the project in the coming months. If you were unable to attend, you can still submit questions – send them to Nate Graham at nsgraham@arlingtonva.us. The Q&A recording will be shared after the event. Visit the [project page](#).

Retail Community Forum

The National Landing Business Improvement District (BID) is partnering with JBG SMITH to host a Retail Community Forum **April 21** to share the latest on evolving retail trends and how they inform JBG SMITH's planning and overall retail strategy for Crystal Drive, Crystal City and the National Landing area. We encourage all voices and diverse perspectives in our community to participate in this effort. [Please register in advance](#). After registering, you will receive a confirmation email containing information and a link to join the meeting. A separate meeting specifically on the Future of the Underground is being planned for later in response to Livability22202 input.

Pentagon City PDSP Update

The focus group consists of designated reps from neighborhoods, developers, and staff who are looking at existing conditions in the PC area, including approved plans/density, roads and pedestrian ways, transit, etc. The goal is to update and expand the 1976 plan resulting in a master plan for the PC area probably later this year though it may slide as the scope presents quite a challenge.

Periodically there will be virtual public forums which anyone can attend. Scheduled virtual meetings are also posted there. The study is currently in Phase 2 through March for Preliminary Planning and Design. Phase 3 from February to April focuses on Work Product Refinement. Phase 4 from April to June will be Review and Presentation of Final Plan. The **March 22** Pentagon City Planning Study workshop focused on economic issues, transportation and land use issues. The presentation is now posted on the County's project website, with notes from breakout groups to follow by the end of the week. In case you prefer a full link, [this is where all project documents and products are posted](#). The next meeting is scheduled for **April 26**.

Crystal City Height Study

The 2010 Crystal City Sector Plan established a 40-year vision for Crystal City and led to the creation of the C-O Crystal City zoning district in 2011. Ten years later, increased interest in redevelopment within Crystal City has driven a need to review the Sector Plan and the C-O Crystal City zoning district to evaluate whether changes to maximum building heights could provide an opportunity to achieve additional community benefits and higher-quality architecture, beyond what was originally identified. The Crystal City Building Heights Study will develop recommendations for updates to height and related regulations found in the Sector Plan and the corresponding C-O Crystal City zoning district. At the March 24 LRPC meeting, the staff presented five scenarios to illustrate possible concepts for permitting additional height within the Crystal City Sector Plan boundaries. The highlights of the discussion will be analyzed by staff and the next iterations will be presented at the next LRPC meeting on **April 27**. The meeting materials can be seen [here](#).

Crystal City Bike Network

The County Department of Environmental Services (DES) has put forward a [draft Crystal City Bike Plan](#) that they were directed by the Board to pursue because of the 1900 Crystal Dr SPRC a year ago. The CCCA and our sister civic associations asked for a broader study of transportation problem on Crystal Drive, but a study of protected bike lanes is all we got. The draft plan is not satisfactory for many reasons. A Sustainable Mobility for Arlington (SUSMO) meeting **March 9** reviewed them and proposed some [alternate ideas](#) for how some streets could better meet those goals in the short term - - without dramatic or disruptive changes -- and some ideas for the long term that need to be documented (or they will never happen). The next meeting will be **April 28**. You can [review the materials](#) here.

Update on Pentagon Row Harris Teeter

At the County Board meeting March 23, many residents spoke against the amendment to remove the condition for a full-scale grocery on Pentagon Row. AED and the applicant assured the Board that they want to keep Harris Teeter (actually owned by Kroger), that it is not planning to go away, and that it has a long-term lease for 10 years, not subject to increased rent. The problem is that HT can unilaterally cancel its lease at any time and finding a replacement grocery could take up to a year, during which the space would remain vacant. This is why they are requesting more flexible language to negotiate in this changed market when few large-style grocery chains would be interested in opening a new store. The County Board then decided to defer the issue until its April meeting due to the complexities of the issue. The Board also instructed the County Manager to "work with the applicant on alternative amendments to Condition #52" and the rest "to balance market conditions

and enforceability with maintaining essential retail offerings to the surrounding community." It will be important to see what the next staff report says for the April meeting--but it has to be better.

Design of Teardrop Parcel Park (S Eads St and Army Navy Drive)

The County launched the last major engagement opportunity for the final draft design of the New Park at South Eads Street and Army Navy Drive project with a March 31 deadline. The park should be in design development and construction drawings development by summer/fall of this year. The construction end is still anticipated to be by 3rd Quarter 2023. See the [project site here](#).

CC2DCA Connector

The County Board approved on March 20 a \$4.23 million contract, awarded through a competitive bidding process, for the conceptual design and environmental review for a Crystal City-National Airport Multimodal Connector. The project is entirely funded by the Federal Government and there is no local matching fund requirement. The duration of work performed under this contract will last approximately three to four years. The scope of work includes an optional task for the Consultant to advance the project's conceptual design completed during the EIS to the Preliminary Engineering level and prepare the bidding documents to advertise the project using a Design-Build construction delivery methodology. The National Landing Business Improvement District developed the concept for the CC2DCA project, even funding its own feasibility study. The total project cost for the connector, including design and construction, was previously estimated at just over \$36 million. The Northern Virginia Transportation Authority committed \$18 million in regional transportation funding to the project last year.

National Cherry Blossom Festival in 22202

Want to take part in the National Cherry Blossom Festival festivities without leaving your



neighborhood? You're in luck! In-person and virtual programs are scheduled as part of the Cherry Blossom Festival programming taking place now through April 11 at Virginia Highlands Park. All programs are FREE; registration required. [Learn more here](#).

Tai Chi for Adults: Mon, April 5, 10-10:45 a.m. [Sign up here](#).

Muscle Conditioning for Adults: Sun., April 11, 2-3 p.m. [Sign up here](#).

Home in a Cherry Tree: Sun., April 11, 2-3 p.m. [Sign up here](#).

The National Landing BID, JBG Smith, and Amazon are sponsors. See the [AHCA website](#) for more details and come on down. This is the [NCBF website](#) with details for the DC area.

Also check out the [National Landing BID's website](#) for a whole list of activities sponsored by the BID,



Amazon, and JBG Smith. In addition to the programs, Synetic Theater will be clowning around with pop-up performances all around Arlington during the National Cherry Blossom Festival! Head to the esplanade at Long Bridge Park to see the National Landing BID's latest installation in the Turn Up the Love series: Eternal Sundown now through April 11. The installation, created by artist Mads Vegas, looks like a setting sun over a city through 140 fluorescent lights in powerful colors. It is made from

approximately 140 reused fluorescent tubes that were originally a part of a pavilion build for the

COP15 climate summit in Copenhagen 2009. While you're at it, see the slick BID [video of National Landing](#).



See the cherry blossom sculptures. If you haven't seen them already, come to the entrance to the Long Bridge Park Esplanade and/or the Water Park to see the 6' cherry blossom sculptures. The bases were installed by Clark Construction, building MetPark and other sites in 22202. The sculptures were painted by local artists and have been placed across DC, Maryland, and Northern Virginia, as part of the National Cherry Blossom Festival. See the [website](#) to

view the complete list of sculpture locations.

Capital Region Rail Vision

Formal agreements between CSX, Amtrak and Virginia Railway Express were signed March 30, clearing the way for further work on the state's \$3.7 billion Transforming Rail in Virginia project. Gov. Ralph Northam announced the agreement between the parties that will ultimately bring about the construction of a new passenger-only bridge over the Potomac River and transfer 386 miles of right-of-way and 223 miles of track from CSX to the commonwealth. By 2030, Northam's plan would nearly double the number of Virginia-supported Amtrak trains for roughly hourly peak service from Washington, D.C. to Richmond, and increase VRE service by about 60%, including weekend service for the commuter rail. The plan includes MARC trains stopping at Crystal City. [See the plan here.](#)

Crystal Houses and Washington Housing conservancy

Good article on [FastCompany.com](#) on the work of WHC with funding by Amazon to address affordable housing.

Potomac Yard Metro Station Prep Work.

Check out this [time lapse video](#) for a look at recent work to prepare for the future Potomac Yard Metro Station, which will be located between Braddock Rd & Reagan National Airport stations. The project team installed prefabricated duct banks below the existing tracks, which will house and protect power and communications cabling for the new station.

Annual Spring Cleaning for Region's Water Pipes Begins April 5

The District of Columbia, Arlington County and the northeastern Fairfax County will begin the regional clean out their tap water network beginning April 5—a safe, annual process.

The Freshman to Open in Crystal City in Mid-April

Area restaurateur Nick Freshman was the first to bet on Amazon's HQ2 when he signed a lease for a new restaurant in Crystal City in 2019, the first retail lease announced by developer and new Amazon Landlord JBG Smith following the tech giant's announcement to locate its headquarters expansion in National Landing, Virginia. The target to open the restaurant's doors at 2011 Crystal Drive was some time in 2020. Freshman even opened a pop-up version of The Freshman in the summer of 2019 in the Crystal City Underground to promote the upcoming restaurant. Then the COVID-19 pandemic hit. [The Freshman](#) is now scheduled to open in mid-April.

BBQ at the Crowne Plaza

A new pop-up restaurant concept with a smoker has opened at the Potomac Social Tavern at the Crowne Plaza hotel in Crystal City called [Tom Bones BBQ](#).

Other Restaurant and Store Changes

A new **Chick-fil-A** opened March 11 in Pentagon City, at 710 12th Street S. on the ground floor of the Whitmer apartment building at the corner of S. Hayes Street and 12th Street S.

Three businesses opened recently at the Fashion Centre at Pentagon City:

Pants purveyor [Bonobos](#)

Soap store [Brookie Girl](#)

Smell seller [Perfume Hut](#)

More are set to open in the near future, including hip tire store [Roll by Goodyear](#), large stuffed animal shop [Squishable](#), fashion retailer [Telos LA](#), and [World Gem and Jewelry](#). [Read more here.](#)

Pentagon Row (rebranded Westport) changes:

Elements Massage is targeting June 5 as its grand opening at 1101 S. Joyce Street. It specializes in customized and therapeutic massage services.

Mattie & Eddie's Irish Bar and Restaurant will open in the spring in the former Siné space, offering "a full Irish farm-to-table menu, a signature style of the chef."

Other new additions opened recently or coming soon include:

Banditos Bar & Kitchen, a Mexican restaurant will take over the space that is currently Thaiphon restaurant, likely in October, and open in March or April 2022.

Scott Chung's **Bun'd Up**

Chung and Kevin Tien's **Wild Tiger BBQ pop-up**

Antonio Ferraro's **Napoli Salumeria**

Johnny Spero and Scott Parker's **Nighthawk Pizza**

Tim Ma's **Lucky Danger**

Cafe and coffee roaster **Origin Coffee Lab and Kitchen**

ARLINGTON COUNTY ISSUES

Share Your Thoughts on the FY 2022- FY 2024 Capital Improvement Plan

The Capital Improvement Plan (CIP) is the County's multi-year plan for building, upgrading, or replacing County facilities and infrastructure. This includes maintenance shops and warehouses, fire stations, public safety buildings and assets, parks and fields, libraries, technology systems, and water, sewer, stormwater and transportation infrastructure. Typically, it is prepared every two years with any adopted general obligation bond referenda presented to voters in November. Because of the COVID-19 pandemic, a one-year CIP was adopted in FY 2021. This year, a multi-year CIP will be presented to the County Board, with the potential for any adopted bond referenda to be presented to voters in November 2021. The County will return to a full ten-year CIP in FY 2023.

To develop the right plan for our community, we need to hear from you. Tell us your priorities. Given the economic impacts of the COVID-19 pandemic, where should we be making investments? Which projects remain critical to our community? Your input will help guide the County Manager's development of the CIP, which will be presented to the County Board in **May**. Find more information on the County's Capital Improvement Plan on the [County budget site](#).

Proposed County Operating Budget

[Want to know the difference between the operating budget and the capital budget?](#)

The Board [considered the 2022 draft budget February 20](#) and advertised no increase in the Calendar Year 2021 base real estate property tax rate, citing the toll the ongoing coronavirus pandemic is taking on residents. The Board also voted to advertise a proposed Stormwater tax rate of 1.7 cents per \$100 of assessed real property value to fund the full cost of operations and planned capital improvements to the County's stormwater infrastructure and flood mitigation. The base real estate tax rate for CY 2021 will remain \$1.013 per \$100 of assessed value. After public hearings in March and April, the budget will be considered for approval on April 17. [See the proposed budget here.](#)

The County Board will hear public testimony on the proposed FY 2022 Operating Budget **April 6**, 7-11 pm. Advance Speaker Signup will be posted one week in advance of the hearing. The meetings will [livestream on the County's website](#) and be broadcast on Arlington TV (Comcast Xfinity 25 or 1085(HD) and Verizon FiOS 39 & 40). More about the [FY22 Budget](#).

Arlington Sparkles with 5 Million Pounds of Recycled Glass and New Income Stream

[Arlington's glass recycling drop-off program](#) continues to shatter expectations—surpassing 5 million pounds (2,500 tons) collected since its debut in 2019. And the effort is officially paying off. The County now receives \$15 per ton for glass collected as the result of a new hauling and commodity contract with a Pennsylvania recycler. Collection bins in Arlington hit the first million mark (500 tons) for glass jars and bottles eight months after the program started in April 2019, then doubled that haul only four months later. Five drop-off sites are spread evenly across the County, meaning a glass recycling bin is only 2.25 miles from any Arlington home.

Lyon's Legacy - excellent historical housing series

ARLNow is publishing an 8-part series - Lyon's Legacy - that covers what happened to Freedman's Village and its citizens and how that happened. Perfect for Black History Month.

The entire series will be here - [the first two parts have been released](#). This tragedy was in our County, close to our neighborhood.

Historic Preservation as Change Management

Take advantage of these 5-minute engagement opportunities for the [Historic Preservation Master Plan Update](#). 2-3 minutes to watch. 2 minutes to respond. An easy way to help guide the County's historic preservation work for the next 10 years.

Arlington County Police Department March Newsletter

In the newest edition of [Monthly News and Highlights from Across the Agency](#), learn about our recent criminal patrol detail in Crystal City designed to address an increase in carjackings in the area. Our efforts to prevent and reduce crime are enhanced by the active involvement of the community and we want to thank you for taking time to learn more about police investigations, crime and crash statistics, engagement activities and department news. See the specific statistics for Crystal City and 22202 on the CCCA website, as well as the recording and presentations from the March 17 CCCA meeting. You can also see the [interactive Crime Map here](#).

OTHER ISSUES

Metro Fast-Tracking Repairs on Yellow Line Bridge and Tunnels

Metro is fast-tracking repairs on the Yellow Line bridge and tunnels. The transit agency is preparing for a major capital project to rehab the 3,000-foot-long Yellow Line bridge that crosses over the Potomac River, connecting D.C. to Arlington. Upgrades will also be made to the fire suppression system on the bridge which is, as the release notes, "beyond its useful life." Additionally, the steel-lined tunnels connecting the Pentagon Metro station to the bridge and the bridge to L'Enfant Plaza station will be repaired. Both the bridge and tunnels date to Metro's original construction more than 40 years ago. [See more here.](#) Metro announced March 22 free shuttle bus service and other travel alternatives to help customers begin planning for this summer's closure of four Green and Yellow line stations scheduled for reconstruction. Starting Saturday, May 29 through Monday, Sept. 6, 2021, Greenbelt, College Park-U of Md, Prince George's Plaza, and West Hyattsville stations on the Green and Yellow lines will be closed.

The station closures are part of Metro's Platform Improvement Project that will completely reconstruct the outdoor platforms at 20 Metrorail stations, making platforms safer and more accessible for customers with disabilities, while also addressing safety concerns and longstanding structural issues. Eleven stations in Virginia have been completed over the past two years, and two additional stations on the **Blue and Silver lines** are currently undergoing platform reconstruction through May 23, 2021. For more information, click here to view the [full news release](#).

National Airport: Arrivals/Bag Claim Roadway to Reopen for Passenger Pick-Up

Beginning on or about Saturday, March 27, private vehicle and ride app pick-up will be available on the Terminal B/C Arrivals/Bag Claim (lower-level) roadway. The roadway is reopening as construction of two new security checkpoint buildings advances. Taxis will continue to pick-up on Arrivals/Bag Claim, outside Door 5. private vehicle and ride app (Lyft/Uber/Via) pick-up will move back to the Terminal B/C Arrivals/Bag Claim (lower-level) roadway. The Ticketing/Check-In (upper) level will remain an additional option for private vehicle and ride app customers.

American Recovery Plan helps Metro avert service cuts and layoffs

Metro expects to avert service cuts and layoffs that had been proposed in its FY22 budget thanks to new federal relief approved by Congress March 10. [Click here to view full news release:](#)

New Federal Register (FR) notice and Extended Comment Period on Airport Noise

On March 11, 2021, the FAA published a new Federal Register (FR) notice extending the public comment period on the National Environmental Survey (NES) from March 15, 2021 to April 14, 2021. [Review the updated FR notice and submit comments to the FAA.](#) In addition, you can check the [County's Aircraft Noise webpage](#) for further updates.

Locals Encouraged to Find Hidden Gems of Arlington on National Walking Day

For National Walking Day on Wednesday, April 7, locals are being encouraged to explore Arlington on foot. Among the new options for doing so: a virtual scavenger hunt. The initiative from WalkArlington and Arlington Transportation Partners is virtual this year due to the coronavirus. Instead, the organizers have assembled resources for local residents, workers and visitors to take

self-guided walking tours through any of the county's 10 urban villages on National Walking Day — or any day, for that matter. Walkers can use an [interactive map](#) to find these gems, which include nature escapes, historical sites, local businesses and public art. Participants will need to [register](#) to access the map.

Synetic Theater Spring Classes Begin April 17

In-Person Classes for Kids and Teens, plus Virtual Fitness for Adults! For Spring 2021, we're moving our classes back to in-person! While we can't wait to have you in the studio again, student safety is our top priority and Synetic will be requiring the use of masks, temperature checks, and social distancing for all in-person classes. For more information, [click here](#).

CRYSTAL CITY CIVIC ASSOCIATION BOARD

President Carol Fuller

Vice President for Policy & Planning Christopher Wimbush

Meeting Secretary Patricia Heath

Communications Director Idris Clay

Membership Liaison Emily Norton

Treasurer Eric Cassel

Join on our website:

<http://www.crystalcitycivic.org/>

Or [Renew Your Membership](#)

Pay through PayPal

Or send a check for \$10 to:

Eric Cassel

Treasurer, CCCA

1300 Crystal Drive #203

Arlington, VA 22202